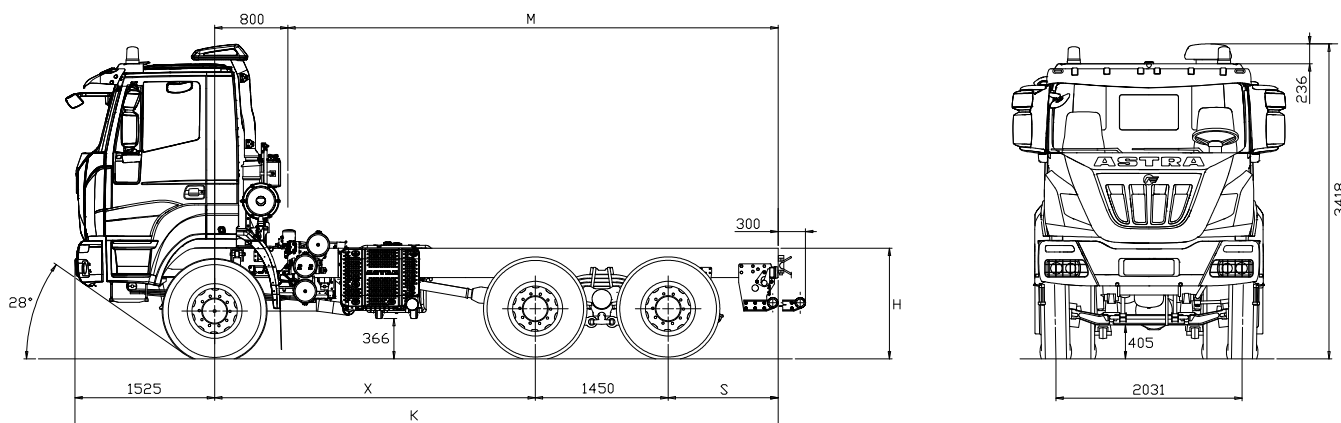

**chassis 6x4
64.45 / 64.50 / 64.56**

DIMENSIONS (mm)

X	K	M max (*)	S	H		TURNING DIAMETER (WALL TO WALL)
				unloaded	loaded	
3500	7675	5350	1200	1191	1129	16800
3800	7975	5650				17800
4500	8675	6350				20000

(*) M max.: indicative value to be confirmed by bodybuilder

(Tyres 13R22.5)

WEIGHT (kg)

X	Distribution net weight (*)			Max technical weight				
	1 st axle	2 nd + 3 rd axle	NET WEIGHT	1 st axle		2 nd + 3 rd axle	Gross Vehicle Weight	Gross Combination Weight
3500	5391	4930	10321	8000 8500 (1)	9000 (1) (2)	32000 (2)	40000 (2)	121.500
3800	5511	4845	10356					
4500	5720	4695	10415					

(*) Weight including oil, fuel, spare wheel, driver 75 kg, with 13R22.5 tyres.

(1) With tyres on front axles 385/65R22.5 or 325/95R24 and reinforced springs (OPT).

(2) With tyres 325/95R24 or max speed limited to 70Km/h depending on pneus type and brand.

Higher speeds are allowed with load reductions subject to Astra technical office approval.

Other tyres available, subject to Astra technical office approval.



ENGINES

CURSOR 13 turbo intercooler electronic common rail with HI-eSCR system. 6 in-line cylinders. Single block head, four valves per cylinder, light alloy pistons. Total displacement: 12.882 cm³. Bore for stroke: 135 x 150 mm. Water cooling. Viscostatic cooling fan. Dry air filter with safety cartridge.

	64.45*	64.50	64.56
Model	CURSOR 13	CURSOR 13	CURSOR 13
Max. power (EEC)	332 kW (450 HP)	368 kW (500 HP)	412 kW (560 HP)
Corresponding rpm	1.900 rpm		
Max. torque (EEC)	2.200 Nm (224 kgm)	2.300 Nm (235 kgm)	2.500 Nm (255 kgm)
Corresponding rpm	970 - 1440	970 - 1525	900 - 1575
Turbine	WG	VGT variable geometry	

* Availability for orders from April 2017, depending on configuration and subject to the Astra technical office approval.



GEARBOX

Manual gearbox, Ecosplit 4 technology with servoshift, 16 synchronised forward speeds + 2 reverse.

ZF 16S2220TO: HD9 64.45

ZF 16S2520TO: HD9 64.50 - HD9 64.56

On request:

Automated **ZF AS-Tronic 16AS2630TO.**

		Speed [kph] calculated at maximum power rpm																		
		Gears																		
		1	2	3	4	5	6	7	8	9	10	11	12	13	14	15	16	RM1	RM2	
ZF16S2220TO ZF16S2520TO	Gear ratios	13.80	11.54	9.49	7.93	6.53	5.46	4.57	3.82	3.02	2.53	2.08	1.74	1.43	1.20	1.00	0.84	12.92	10.80	
	Rear axle ratio	4.229	6.7	8.0	9.7	11.7	14.2	16.9	20.2	24.2	30.6	36.5	44.4	53.1	64.6	77.0	92.4	110.0	7.2	8.6
		5.009	5.7	6.8	8.2	9.8	11.9	14.3	17.1	20.4	25.8	30.8	37.5	44.8	54.6	65.0	78.0	92.9	6.0	7.2
		5.558	5.1	6.1	7.4	8.9	10.8	12.9	15.4	18.4	23.3	27.8	33.8	40.4	49.2	58.6	70.3	83.7	5.4	6.5
		6.095	4.6	5.6	6.8	8.1	9.8	11.7	14.0	16.8	21.2	25.3	30.8	36.8	44.8	53.4	64.1	76.3	5.0	5.9
		6.588	4.3	5.1	6.3	7.5	9.1	10.9	13.0	15.5	19.6	23.4	28.5	34.1	41.5	49.4	59.3	70.6	4.6	5.5

Max speed 90 km/h. Other speeds available, subject to the Astra technical office approval.



P.T.O.

On request:

Gearbox	ZF 16S2220TO ZF 16S2520TO	Max. torque	Application
P.T.O.	Ratio	Nm	
ZF NH/1b	0,91/1,09:1	1000	For tipping unit pumps, pumps for cranes, ecc..
ZF NH/1c	0,91/1,09:1	1000	For tipping unit pumps, unit pumps for concrete, pumps for cranes, ecc..
ZF NH/4c	1,17/1,40:1	430	For tipping unit pumps, ecc..
ZFN221/10+NL /1c	1,75/2,09:1+0,91/1,09:1	560+600	double PTO for concrete pumps

ZF NMV 221 Power take-off (ratio 0,98:1) max available torque 2000 Nm for concrete pumps.

Power take-off Multipower (ratio 1,29:1) max available torque 900 Nm for concrete mixers.



CLUTCH

Single dry plate, diameter 17". Pull type engagement with diaphragm spring.
Hydro-pneumatic power steering engagement control, with driven disk wear recovery slave cylinder.



AXLES

FRONT

Steering, hot moulding in high tensile steel.
Wheel stud protection.

REAR

Double drive axles.
Double reduction: crown wheel and pinion centrally and epicyclical group in wheel hubs.
2nd axle with torque distributor to the two rear axles. Lockable differentials from driver seat. Tandem assembled to the chassis by reaction rods with silentblock.

On request:

Rear-axle ratio 1:4,229
Rear-axle ratio 1:5,009
Rear-axle ratio 1:5,558
Rear-axle ratio 1:6,095
Rear-axle ratio 1:6,588



SUSPENSIONS

FRONT

1st axle, parabolic springs, n° 4 leaves 24x90 mm, with hydraulic shock absorbers.
Standard stabilizer bar.

On request:

Reinforced parabolic springs, n° 5 leaves 24x90 mm.
Mandatory with 9 t axle load.

REAR

Parabolic springs, swivelling on central pin: n° 4 leaves 40x100 mm.

On request:

stabilizer bar on 2nd axle.
stabilizer bar on 3rd axle.
Extra-reinforced conventional springs, n° 10 leaves 25x100 mm.



CHASSIS

Special steel with high tensile strength limit, two flat and parallel side members (width 820 mm.), C section (320x90x10mm), cross members bolted to the frame.
R.B.M. (Rail Bending Moment): 202.020 Nm (20.593 Kgm.).
Steel front bumpers with headlamp protection grids, front manoeuvring hook, rear underrun bar, steel fuel tank capacity 300 litres.

On request:

Rapid pneumatic connection for tyre inflation.
Rear underrun bar in set back position.
Extra long underrun bar for concrete mixer.
Rear manoeuvring hook.
Rear automatic towing hook.
Rubber mudguards on 2nd and 3rd axle.



TYRES

FRONT: 13R22,5 156/150 G Single tubeless

REAR: 13R22,5 156/150 G Twin tubeless

Spare wheel on the chassis.

Other Possible combinations:

TYRES	ASSEMBLY	
	FRONT	REAR
315/80 R22,5 156/150K	S	D
385/65 R22.5 160J (*)	S	
315/80 R22,5 156/150K		D
325/95 R24 162/160K (*)	S	D

S single

D double

(*) Mandatory with 9 ton front axle load.

Other tyres available, subject to Astra technical office approval.



PNEUMATIC SYSTEM

Two-cylinder 630 cc compressor , APU (Air Processing Unit) that includes: regulation valve set at 10.3 bar, drier, 4-way safety valve, pressure reduction valve for parking circuit and services. 3 air tanks, capacity 30 litres + 2 with 20 litres.
ABS system and EBL (Electronic Brake Limiter).



BRAKES

Front and rear "duo-duplex" self-adjusting wedge type brakes with automatic play take-up.

Total net braking surface 9.276 cm². ABS + EBL.

Service brake: Pedal controlled air brake, acting on all wheels.

Solo vehicles, two independent circuits, one for 1st axle, one for 2nd and 3rd axle; 1st category wheels anti-lock system.

Towing vehicles, three independent circuits, one for 1st axle, one for 2nd and 3rd axle and another for the trailer; 1st category wheels anti-lock system.

Emergency brake: Incorporated in service brake.

Parking brake: Manual spring-type mechanical with pneumatic control acting on 2nd and 3rd axle wheels.

IVECO SUPER ENGINE BRAKE engine brake:

HD9 450 HP braking power 325 kW (436 HP).

HD9 500/560 HP braking power 463 kW (621 HP).

On request:

Hydraulic intarder.

OFF/ROAD button for excluding ABS for speed < 15 kph.



STEERING

ZF 8098 quadrilateral power steering on front axle wheels with variable ratio 1:22.2/1:26.2 with auxiliary cylinder.

Circuit with main hydraulic pump on engine and emergency pump on gearbox.

Steering rods with self-lubricating joints.

Height and inclination pneumatic adjustable steering column.



SERVICE DATA (l)

Engine oil sump (and filters)	28 (+ 2,5)
Gearbox oil	14,5
Power steering oil.....	8,5
Cab tipping oil	1
Clutch circuit oil.....	0,5
Integral PTO oil.....	3
Intermediate axle with final red. oil.....	27
Rear axle with final red. oil	16
Cooling system water.....	33
Diesel.....	300
AD Blue	50



ELECTRICAL SYSTEM

Voltage: 24 V
 Alternator generator 90 A - 28 V (2520 W).
 Accumulators: 2 in series, 170 Ah.
 Starter motor 24 V 5,5 kW.
 Mechanically controlled electrical circuit breaker.
 Anti-block system ABS with 4-conduits and 4-electric valveselectronic system.
 Phonic wheels and sensors on 1st and 3rd axle.
 1 electrical joint 7-pole(ISO 7638) for trailer ABS(if applicable).
 1 electrical joints 15-pole(ISO 12089-4091) for trailer lighting (if applicable).
 Headlamp geometry corrector .
 Electrical provision for outfitters.
 Provision for diagnostics.
 Provision for radio/cb (without speakers)
 Glow plug for cold start.
On request:
 Reverse alarm;



CAB

White cab built in galvanized pressed steel with hydraulic tilting up to 60°. Cab suspension with 4 helicoidal springs with coaxial shock absorbers and integrated dampers, anti-roll bar and end-of-stroke pads. Tinted electric door windows. Internal panels completely washable and fireproof. Rapid pneumatic connection for cab cleaning. 4-speed ventilation and heating system with air recirculation system. Air suspended 3-way adjustable driver seat with seat belts. Mechanical passenger seat with seat belts.

On request:
 Air conditioning with anti-pollen filter
 Cab rear window.
 Car radio RDS, CD.
 Car radio RDS, CD with steering wheel controls
 Car radio RDS, CD, MP3 Bluetooth technology.
 External sun visor.
 Heated and electric powered rear view mirrors.
 Remote controlled and centralized closing of doors.
 Roof hatch.
 Rotating lights on top of the cab.



INSTRUMENTATION

Dashboard and ergonomic instrument board contain the function buttons and the identification commands.

Indicator lights: engine oil low pressure, alternator charging low, main beam lights, side lights, engine warm-up, rear fog light, hazard lights, tractor turn indicators, trailer turn indicators (if applicable), rotating lights,cab lifted,axles differential locked, differential lock, front brakes air pressure low, rear brakes air pressure low, trailer brakes air pressure low (if applicable), parking brake engaged, splitter (reduction on), slow speeds (1-4/9-12),power take-off on (if applicable) air filters clogged, power steering oil level low, rear view mirrors heated (if applicable), tractor ABS, trailer ABS (if applicable), main steering circuit failure, steering auxiliary circuit failure, low ureas' level.

ASTRA Veicoli Industriali
 Via Caorsana, 79
 29122 Piacenza (Italy)
 Tel. +39-0523/54311
 Fax +39-0523/591773
 www.iveco-astra.com

DEALER

Characteristics and equipment are subject to changes without prior notice.

Technical data and general specifications - validity to be checked according to each individual configuration